

**ELECTRICAL LEGEND**

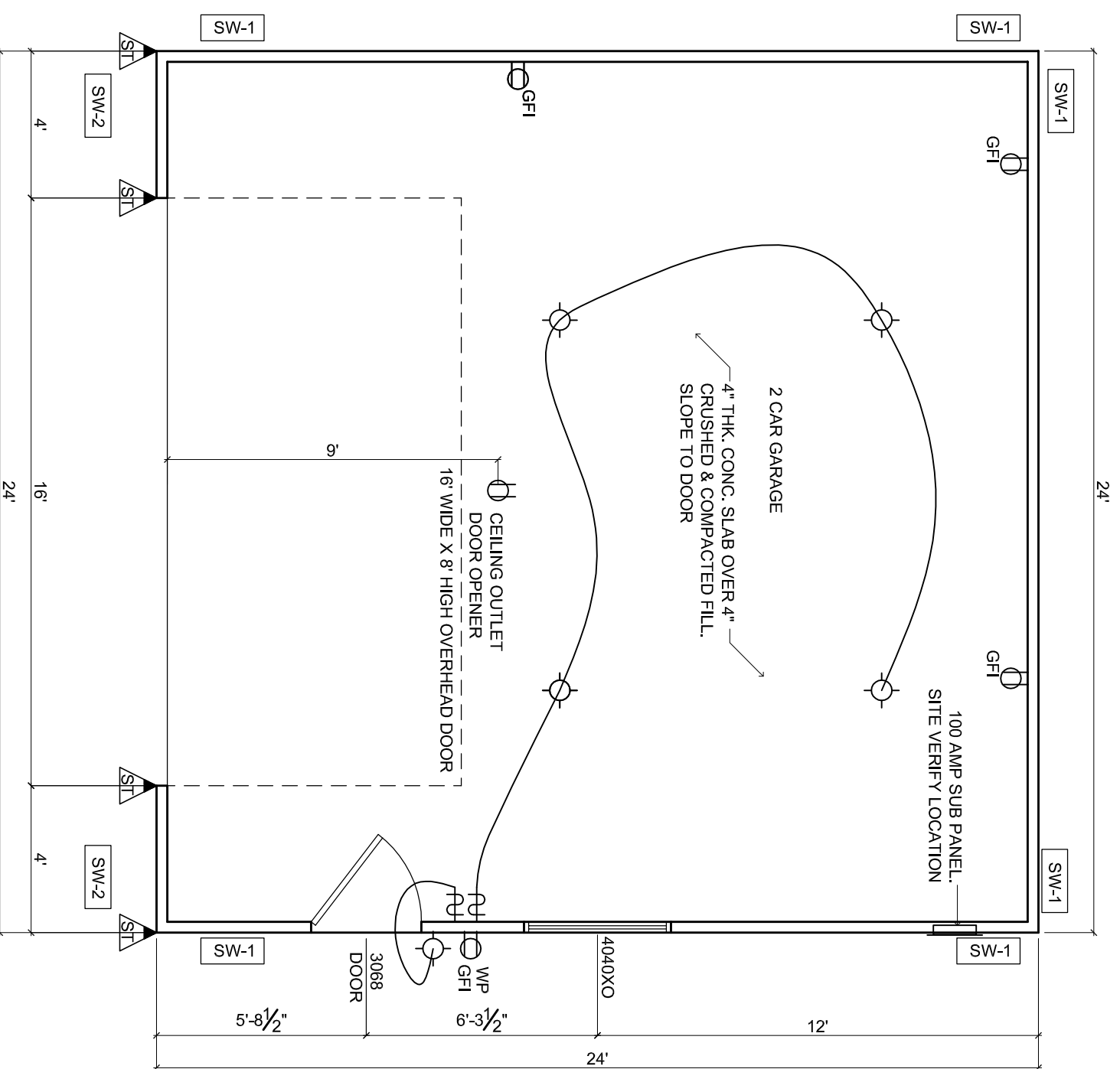

**1 FLOOR PLAN**

1/2" = 1'-0" NOTE: SEE ROOF FRAMING PLAN FOR BEAM INFORMATION

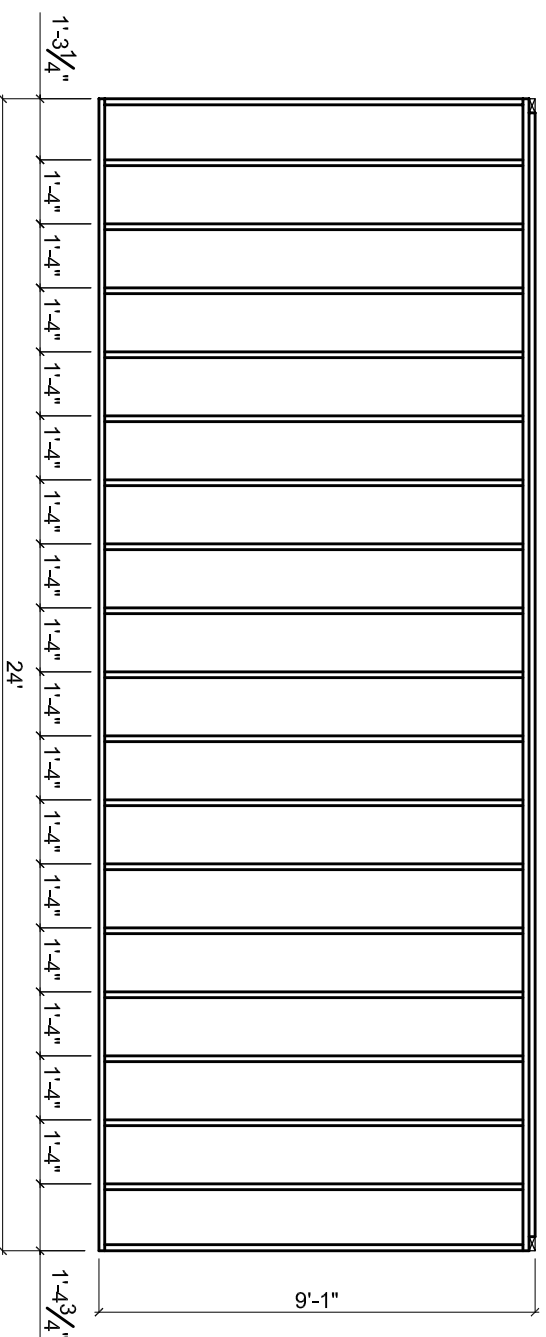

**2 REAR WALL FRAMING PLAN**

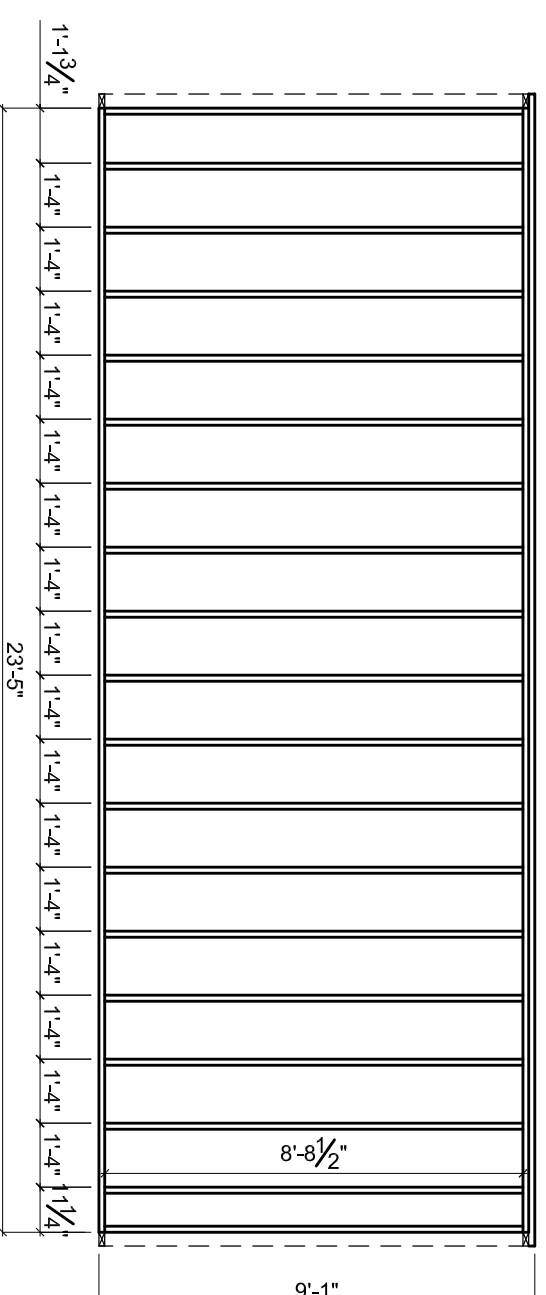

**3 LEFT WALL FRAMING PLAN**

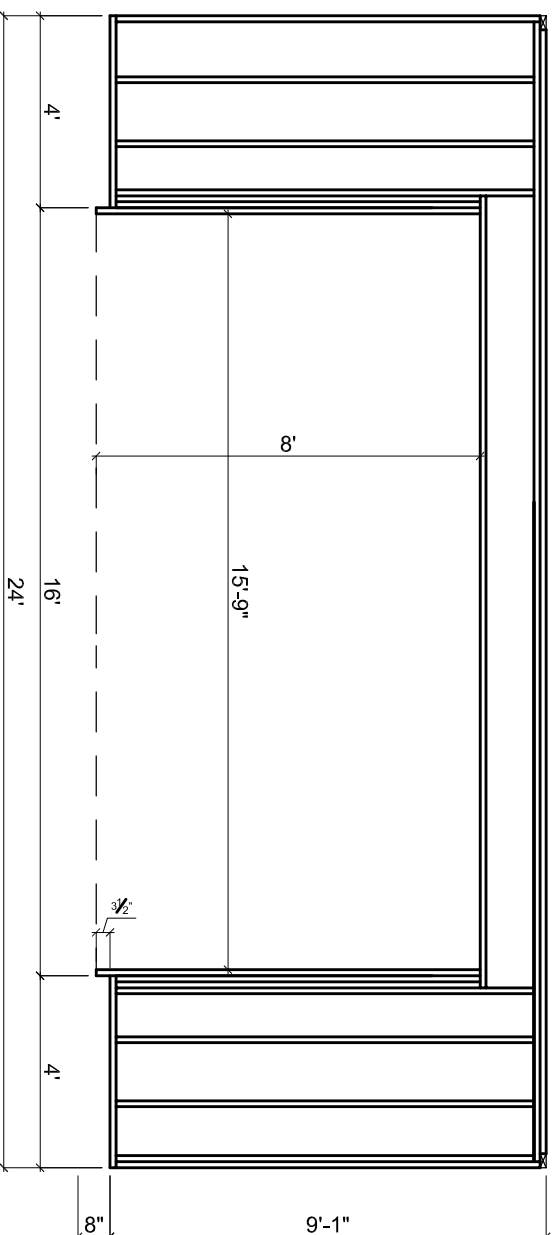

**4 FRONT WALL FRAMING PLAN**

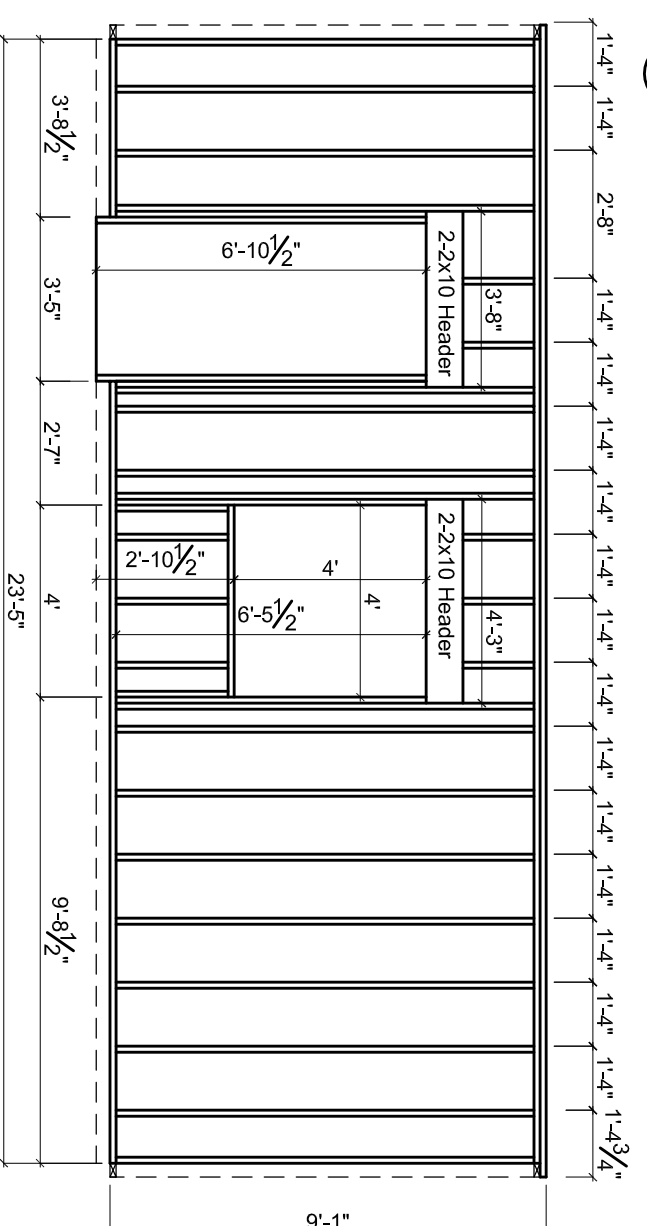

**5 RIGHT WALL FRAMING PLAN**

BRACED WALL FASTENING SCHEDULE				IRC TABLE R602.3(1)(3)
MARK	SHEATHING	EDGE NAILING	FIELD NAILING	SILL BOLTING AT FOUNDATION
BW-1	7/16" PLYWOOD / O.S.B.	8d @ 6" O.C.	8d @ 12" O.C.	1/2" ANCHOR BOLT @ 24" O.C.
PF	PORTAL FRAME WALL PANEL PER IRC 602.10 SEE DETAIL (S12)			
ABW	ALTERNATE BRACED WALL PANEL, (32" LENGTH WITH 1800 LB.) SEE IRC TABLES 602.10.5 - 602.10.6, 1 - FIGURE 602.10.6.1 (S12)			
1- PROVIDE BLOCKING BETWEEN CEILING JOISTS TO TOP PLATE. TOENAIL 3-8D (2 1/2" X 0.131) 2- NAILS ARE SMOOTH-COMMON, BOX OR DEFORMED SHANKS. 3- RAFTER OR TRUSS TO PLATE. 3-10D COMMON (3" X 0.148") 4- ANCHOR BOLTS SHALL BE EMBED INTO CONCRETE A MINIMUM OF 7". NOT MORE THAN 6'-0" O.C. AND WITHIN 12" OF ENDS. (2018 IRC R403.1.6) 5- PLATE WASHERS INSTALLED PER (2018 IRC R602.11.1)				

PLAN NO. 24x24-2C1D

**GARAGE PLANS**

Big Idea Designs  
 www.icreatables.com  
 707-901-SHED(7433)

FLOOR PLAN  
 WALL FRAMING PLANS  
 ELECTRICAL

SCALE: 3/8" = 1'-0"  
 DATE:

**A2.1**